

ZINC ALLOY BOX

AX-PBOX70114

- Dimensions: 114L x 70W X 25 H (mm)
- Standard instruction Zinc alloy material and surface is coated with chrome
- Weight: 0.2kg

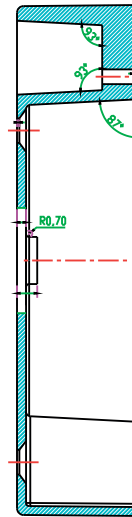
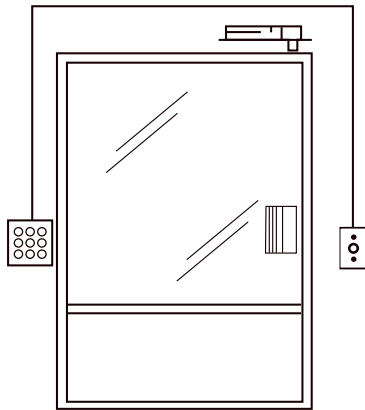

25.0

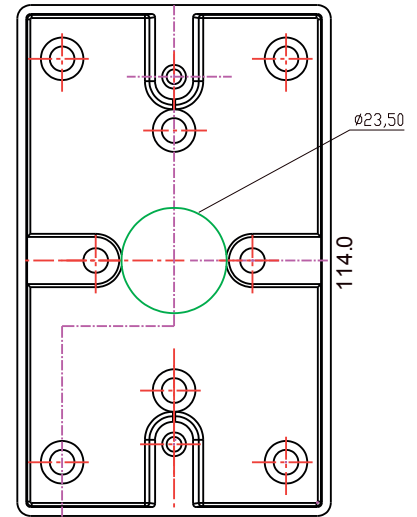

70.0

axceze®



ZINC ALLOY BOX

AX-PBOX70114

- Dimensions: 114L x 70W X 25 H (mm)
- Standard instruction Zinc alloy material and surface is coated with chrome
- Weight: 0.2kg

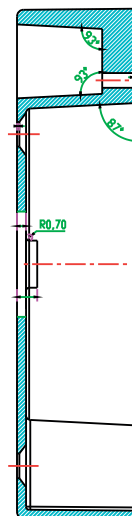
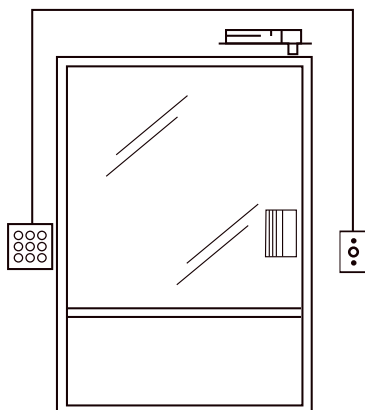

25.0

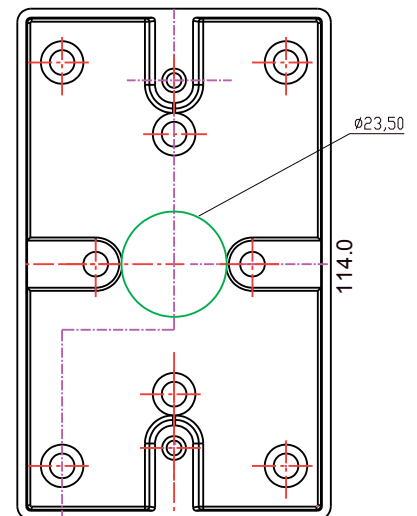

70.0

axceze®



axceze®

axceze®