

16-Port 10/100TX 802.3at PoE Ethernet Switch



Centralized Power Distribution for Fast Ethernet PoE Networking

To fulfill the needs of higher power required PoE network applications with 10/100Mbps transmission, PLANET FNSW-1600P's PoE power output is upgraded from IEEE 802.3af PoE to IEEE 802.3at PoE+. It features 16 10/100BASE-TX RJ45 ports with IEEE 802.3at PoE+ injector function that combines up to 30 watts of power output and data per port over one Cat5E/6 Ethernet cable. It is specifically designed for powered devices (PDs) such as PTZ cameras that consume high power.

Maximum Wire-speed Throughput

The FNSW-1600P features a high-performance switch architecture capable of providing the non-blocking 3.2Gbps switch fabric and wire-speed throughput as high as 2.38Mpps, thus increasing the bandwidth demand for LANs. Besides, the 802.3x full-duplex flow control function of the FNSW-1600P enables PDs and servers to be directly connected to the Switch for wire-speed packet transfer without the risk of packet loss.

Easy and Cost-effective Network Deployment

With the simultaneous transmission of data and power over Ethernet over a cable, the FNSW-1600P does not need extra cables and electrical outlets on the wall, ceiling or any unreachable place for extended network deployments. It thus helps to lower the installation costs, simplify the installation effort and eliminate the need for electricians. With a total power budget of 125 watts, the FNSW-1600P is ideal for small businesses and workgroups wanting to deploy a PoE network equipped with wireless access points, IP surveillance cameras and IP phones in any places easily and efficiently.

Physical Port

- 16 10/100BASE-TX RJ45 ports with IEEE 802.3at PoE+ injector

Power over Ethernet

- Complies with IEEE 802.3at Power over Ethernet Plus/mid-span PSE
- Supports PoE power up to 30 watts for each PoE port
- 125W PoE power budget
- Auto detects powered device (PD)
- Circuit protection prevents power interference between ports
- Remote power feeding up to 100m

Switching

- Hardware-based 10/100Mbps auto-negotiation and auto MDI/MDI-X
- Flow control for full duplex operation and back pressure for half duplex operation
- Integrates address look-up engine, supporting 8K absolute MAC addresses
- Automatic address learning and address aging

Case and Installation

- 19-inch desktop size, 1U height
- LED indicators for PoE ready, PoE activity
- 2 silent fans to provide stable and efficient power performance
- Rack-mountable, Plug-and-Play installation

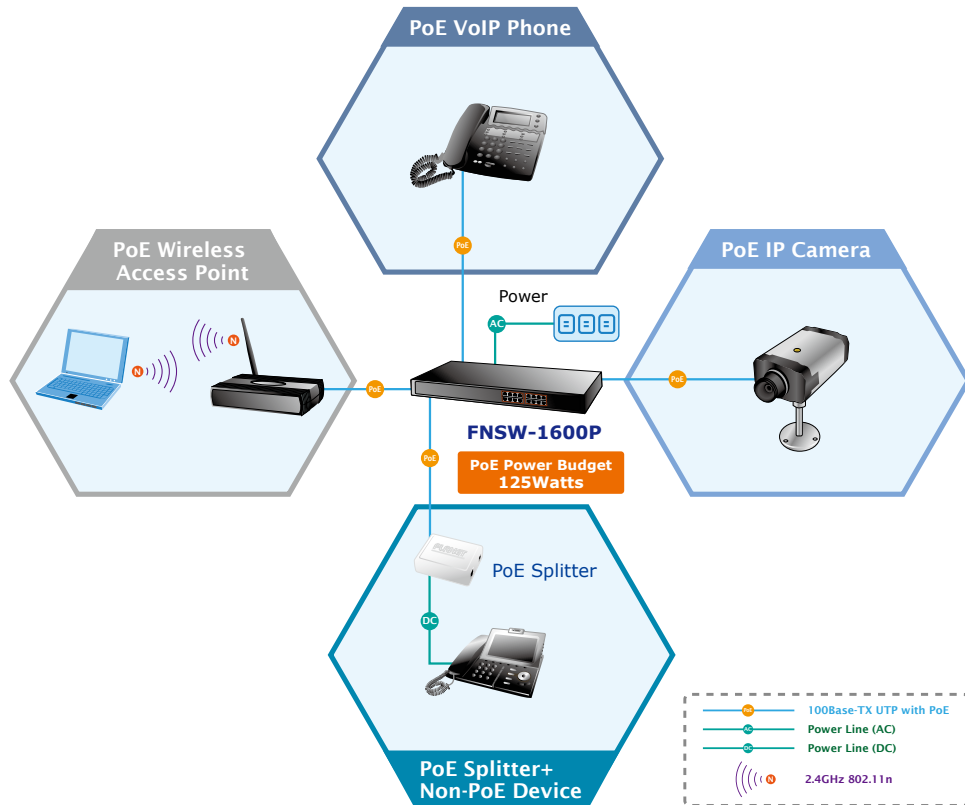

Applications

Power Centrally Controlled

Providing 16 802.3at PoE+ in-line power interfaces, the FNSW-1600P can easily build a power that centrally controls IP phone system, IP camera system and wireless AP group for enterprises. IP cameras can be installed around the corner in the company or campus for surveillance demands. Wireless APs can be deployed to build a wireless roaming environment. Without the need for electrical outlets, the Switch makes the installation of cameras and wireless APs easier and more efficient.

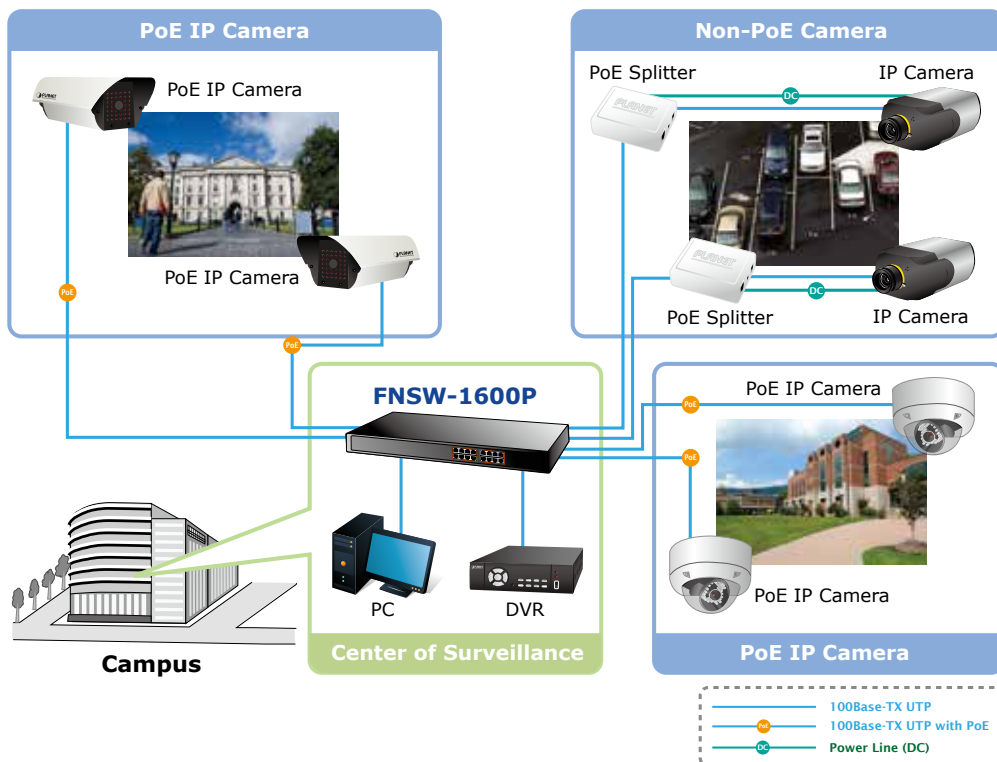

Specifications

Model	FNSW-1600P
Hardware Specifications	
Copper Ports	16 10/100BASE-TX RJ45 auto-MDI/MDI-X ports
PoE Inject Port	16 ports with 802.3at/af PoE injector function with Port-1 to Port-16
LED Indicators	System: Power(Green) Port 1 to Port 16: 10/100 LNK/ACT (Green) PoE-in-Use (Orange)
Switch Architecture	Store-and-Forward
Address Table	8K entries, automatic source address learning and aging
Switch Fabric	3.2Gbps/non-blocking
Throughput (packet per second)	2.38Mpps@64 bytes
Power Requirements	AC 100~240V, 50/60Hz, 2A max.
Power Consumption	Max. 133.3 watts/457.4 BTU
Dimensions (W x D x H)	445 x 207 x 45 mm
Weight	2330g
Power over Ethernet	
PoE Standard	IEEE 802.3af Power over Ethernet/PSE IEEE 802.3at Power over Ethernet Plus/PSE
PoE Power Supply Type	Mid-span
PoE Power Output	Per port 52V DC (max.30.8 watts)
Power Pin Assignment	4/5(+), 7/8(-)
PoE Power Budget	125 watts
Standards Conformance	
Regulatory Compliance	FCC Part 15 Class A, CE
Standards Compliance	IEEE 802.3 10BASE-T IEEE 802.3u 100BASE-TX/100BASE-FX IEEE 802.3x flow control and back pressure IEEE 802.3af Power over Ethernet IEEE 802.3at Power over Ethernet Plus
Environment	
Regulatory Compliance	FCC Part 15 Class A, CE
Standards Compliance	IEEE 802.3 10BASE-T IEEE 802.3u 100BASE-TX/100BASE-FX IEEE 802.3x flow control and back pressure IEEE 802.3af Power over Ethernet IEEE 802.3at Power over Ethernet Plus
Environment	
Operating	Temperature: 0 ~ 50 degrees C Relative Humidity: 5 ~ 95% (non-condensing)
Storage	Temperature: 0 ~ 50 degrees C Relative Humidity: 5 ~ 95% (non-condensing)

Ordering Information

FNSW-1600P	16-Port 10/100TX 802.3at PoE+ Ethernet Switch
------------	---

Related Products

FGSW-1822VHP	16-Port 10/100TX 802.3at PoE + 2-Port Gigabit TP/SFP Combo Ethernet Switch with LCD PoE Monitor (300W)v
FSD-808HP	8-Port 10/100Mbps 802.3at PoE Desktop Switch
FGSD-910HP	8-Port 10/100Mbps 802.3at PoE + 1-Port 1000Mbps Desktop Switch (130W)
FSD-504HP	4-Port 10/100Mbps 802.3af/at PoE + 1-Port 10/100Mbps Desktop Switch (60W)
POE-E201	IEEE 802.3at Power over Gigabit Ethernet Extender
POE-E202	1-Port 802.3at PoE+ to 2-Port 802.3af/at Gigabit PoE Extender

PLANET Technology Corporation

11F., No.96, Minquan Rd., Xindian Dist., New Taipei City 231,
Taiwan (R.O.C.)
Tel: 886-2-2219-9518 Fax: 886-2-2219-9528
Email: sales@planet.com.tw www.planet.com.tw



PLANET reserves the right to change specifications without prior notice. All brand names and trademarks are property of their respective owners. Copyright © 2017 PLANET Technology Corp. All rights reserved.

FNSW-1600Pv3